



maitland library
city council

POKEMON PLANTER BOXES

Instruction Sheets

For more activities go to maitlandlibrary.com.au/



Make a Bulbasaur Planter

You will need:

Clear plastic bottle

Acrylic paint

Black marker

Scissors or utility knife (you will need an adult to use this)

Pencil

Paint brush

Craft glue

Paper or white card

Soil and a succulent (any type)

Instructions:

1. Collect a plastic bottle then wash and dry it.
2. Use the black marker to trace the shape of Bulbasaur's head and ears on the outside of the plastic bottle.
3. Use the scissors or utility knife to cut along the marker line and remove the top of the bottle. Remember an adult may have to help you with this step.
4. Prepare the paint to match the colouring of Bulbasaur. Hint try white, blue and green.
5. Paint the bottle making sure that it is covered entirely – allow to dry.
6. While the paint is drying, trace the template on to paper or white card. Paint or use markers to fill in the pattern.
7. Glue on the eyes and Bulbasaur's markings then use a marker to draw on Bulbasaur's mouth, teeth and nose.
8. Fill your planter with soil and a succulent.



Thanks to rufflesandrainboots.com/bulbasaur-planter/ for the activity idea.

Make a Chikorita Planter

You will need:

Plastic bottle

Acrylic paint

Black marker

Scissors or utility knife (you will need an adult to use this)

Pencil

Paint brush

Craft glue

Paper or white card

Soil and a succulent (any type)

Instructions:

1. Collect a plastic bottle then wash and dry it.
2. Use the black marker to trace the shape of Chikorita's head and ears on the outside of the plastic bottle.
3. Use the scissors or utility knife to cut along the marker line and remove the top of the bottle. Remember an adult may have to help you with this step.
4. Prepare the paint to match the colouring of Chikorita. Hint try colours white, blue and green.
5. Paint the bottle making sure that it is covered entirely – allow time to dry.
6. While the paint is drying, trace the template of the Chikorita's eyes or other patterns on to paper or white card. Paint or use markers to fill in the pattern.
7. Glue on the eyes and draw Chikorita's markings and mouth.
8. Fill your planter with soil and a succulent.



Thanks to [instructables.com/id/DIY-Recycled-Pokemon-Planters/](https://www.instructables.com/id/DIY-Recycled-Pokemon-Planters/)

Make a Shaymin Planter

You will need:

Plastic bottle

Acrylic paint

Black marker

scissors or utility knife (you will need an adult to use this)

Pencil

Paint brush

Craft glue

Paper or white card

Soil and a succulent (any type)

Instructions:

1. Collect a plastic bottle then wash and dry it.
2. Use the black marker to trace the shape of Shaymin's head on the outside of the plastic bottle.
3. Use the scissors or utility knife to cut along the marker line and remove the top of the bottle. Remember an adult may have to help you with this step.
4. With the spare parts of the bottle you will need to cut out two flower patterns with six petals on each. Remember an adult may have to help you with this step.
5. Paint the entire bottle cut out with white acrylic paint. Once the first coat dries, apply another coat of white paint. Wait until the paint is completely dry.
6. Paint the cut out plastic flowers with pink and yellow acrylic paint. Allow the paint to dry entirely.
7. Use super glue to attach the two flower patterns on two sides of Shaymin's head (on the bottle cut out).
8. Prepare the eyes and mouth from coloured craft paper and use black marker to add a little shade to the eyes. Glue the eyes on the bottle cut out, below the flowers.
9. Glue the mouth cut out and use a black marker to draw the nose of Shaymin on the bottle planter.
10. Fill your planter with soil and a succulent.



Thanks to [instructables.com/id/DIY-Recycled-Pokemon-Planters/](https://www.instructables.com/id/DIY-Recycled-Pokemon-Planters/)

Make a Hoppip Planter

You will need:

Plastic bottle

Acrylic paint

Black marker

Scissors or utility knife (you will need an adult to use this)

Pencil

Paint brush

Craft glue

Paper or white card

Soil and a succulent (any type)

Instructions:

1. Collect a plastic bottle then wash and dry it.
2. Trace the ears and head of Hoppip on the outside of the bottle.
3. Use the scissors or utility knife to cut along the marker line and remove the top of the bottle. Remember an adult may have to help you with this step.
4. Paint the bottle cut out using pink acrylic paint.
5. Cut out the eyes from yellow craft coloured paper and draw a black border around the eyes with a black marker. Stick the eyes on the bottle, on their appropriate places.
6. Cut out the mouth pattern of Hoppip from pink coloured craft paper and stick it on the Hoppip bottle cut out.
7. Use black marker to draw shades on the ear parts of the Hoppip bottle cut out.
8. Fill your planter with soil and a succulent.

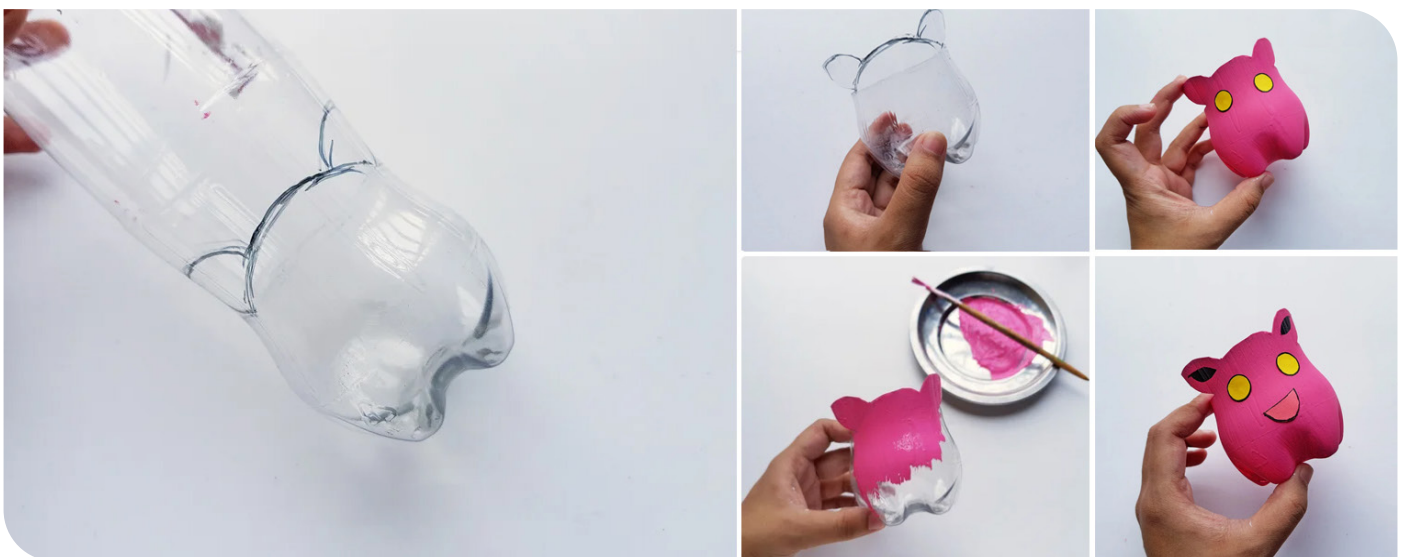

Thanks to [instructables.com/id/DIY-Recycled-Pokemon-Planters/](https://www.instructables.com/id/DIY-Recycled-Pokemon-Planters/)

Make a Chespin Planter

You will need:

Plastic bottle

Acrylic paint

Black marker

Scissors or utility knife (you will need an adult to use this)

Pencil

Paint brush

Craft glue

Paper or white card

Soil and a succulent (any type)

Instructions:

1. Collect a plastic bottle then wash and dry it.
2. Use the black marker to trace the shape of Chespin head on the outside of the plastic bottle.
3. Use the scissors or utility knife to cut along the marker line and remove the top of the bottle. Remember an adult may have to help you with this step.
4. For Chespin, use yellow acrylic paint. Allow the base paint to dry. Apply another coat if necessary.
5. Use a pencil to draw the patterns of Chespin on the painted bottle cut out. Use brown and green paint to fill the traced patterns to resemble the Chespin.
6. Similarly, draw and paint the eyes on a white paper and then cut them out.
7. Cut out the nose from orange coloured craft paper and use white paper to cut out the teeth for Chespin.
8. Glue the prepared paper patterns on the painted bottle to complete the Chespin planter.
9. Fill your planter with soil and a succulent.

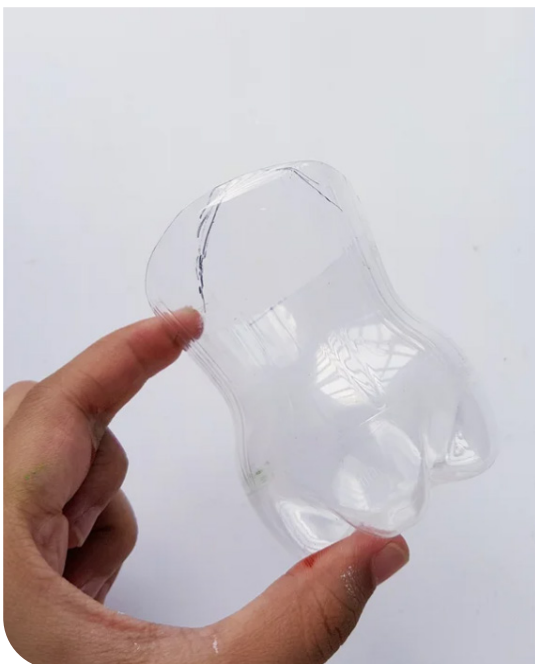

Thanks to [instructables.com/id/DIY-Recycled-Pokemon-Planters/](https://www.instructables.com/id/DIY-Recycled-Pokemon-Planters/)